



Architectural Control Committee Plan and Specification Review Determination Additions Application

Architectural Control Committee approval includes esthetic feature only and does not imply or warrant any structural integrity. This approval is not based on an engineering review of the site plan or structure.

| | | | | | | | | | | | | | | | | |
|---|--|--|------------|---|-------------|------------|--|---|------------|--|---|------------|---|---|------------|---|
| Submittal # : <u>15772</u> | 1. Applicant Information: Applicant Name: <u>JEFF & ANGIE KROELLER</u> Phone #: <u>206 510 0825</u> Applicant Address: <u>1824 1163rd Pl. S.E</u> | | | | | | | | | | | | | | | |
| Date Submitted : <u>3/15/21</u> | 2. Site Information: Lot # : <u>74</u> Division: <u>Amberleigh</u> Site Address : <u>SAME</u> | | | | | | | | | | | | | | | |
| ATTACH PAINT SAMPLES HERE | 3. Type of Structure: Deck: _____ Patio: _____ Hot Tub: _____ Addition: _____ Separate Building: _____ Other (specify): _____ | | | | | | | | | | | | | | | |
| | 4. Description of Structure: (Include exact location, type of materials, style color, etc.) <u>LANDSCAPING ALONG WALKWAY, CORNER</u> <u>FRONT YARD</u> | | | | | | | | | | | | | | | |
| ACC Insp. Month | 5. Proposed Construction Drawings: IMPORTANT: Please include a sketch of the property on the next page of this form (per item #3 of "Basic Policy for Additional Construction" attached.) An elevation drawing or a perspective drawing of the proposed construction must also be attached to this form (per item #2 of "Basic Policy for Additional Construction".) | | | | | | | | | | | | | | | |
| ACC Insp. | Pursuant to the provision of Article VIII, Paragraphs 8.1, 8.2 and 8.2.1, 8.2.2, 8.2.3, 8.3, 8.3.1, 8.3.2, and 8.3.3, and Article IX of the MILL CREEK DECLARATION OF COVENANTS, the following determination by the Architectural control Committee is hereby granted: Approval subject to the following changes: | | | | | | | | | | | | | | | |
| Inspection Notes: | Rejected for the following reasons: | | | | | | | | | | | | | | | |
| | <table border="0"> <tr> <td>(<input checked="" type="checkbox"/>) Approve</td> <td>() Reject</td> <td><u>[Signature]</u> Date: <u>3/16/21</u></td> </tr> <tr> <td>() Approve</td> <td>() Reject</td> <td>SUB-ASSOCIATION (IF APPLICABLE) Condominiums & Townhomes</td> </tr> <tr> <td>(<input checked="" type="checkbox"/>) Approve</td> <td>() Reject</td> <td><u>Michael Bement</u> Date: <u>3-10-21</u></td> </tr> <tr> <td>(<input checked="" type="checkbox"/>) Approve</td> <td>() Reject</td> <td><u>Becky Edy</u> Date: <u>3/16/2021</u></td> </tr> <tr> <td>(<input checked="" type="checkbox"/>) Approve</td> <td>() Reject</td> <td><u>Earl Bardin</u> Date: <u>3/19/2021</u></td> </tr> </table> | (<input checked="" type="checkbox"/>) Approve | () Reject | <u>[Signature]</u> Date: <u>3/16/21</u> | () Approve | () Reject | SUB-ASSOCIATION (IF APPLICABLE) Condominiums & Townhomes | (<input checked="" type="checkbox"/>) Approve | () Reject | <u>Michael Bement</u> Date: <u>3-10-21</u> | (<input checked="" type="checkbox"/>) Approve | () Reject | <u>Becky Edy</u> Date: <u>3/16/2021</u> | (<input checked="" type="checkbox"/>) Approve | () Reject | <u>Earl Bardin</u> Date: <u>3/19/2021</u> |
| (<input checked="" type="checkbox"/>) Approve | () Reject | <u>[Signature]</u> Date: <u>3/16/21</u> | | | | | | | | | | | | | | |
| () Approve | () Reject | SUB-ASSOCIATION (IF APPLICABLE) Condominiums & Townhomes | | | | | | | | | | | | | | |
| (<input checked="" type="checkbox"/>) Approve | () Reject | <u>Michael Bement</u> Date: <u>3-10-21</u> | | | | | | | | | | | | | | |
| (<input checked="" type="checkbox"/>) Approve | () Reject | <u>Becky Edy</u> Date: <u>3/16/2021</u> | | | | | | | | | | | | | | |
| (<input checked="" type="checkbox"/>) Approve | () Reject | <u>Earl Bardin</u> Date: <u>3/19/2021</u> | | | | | | | | | | | | | | |



COMMUNITY ASSOCIATION

ESTABLISHED 1975

Proposed Construction Drawing
(Property Sketch):

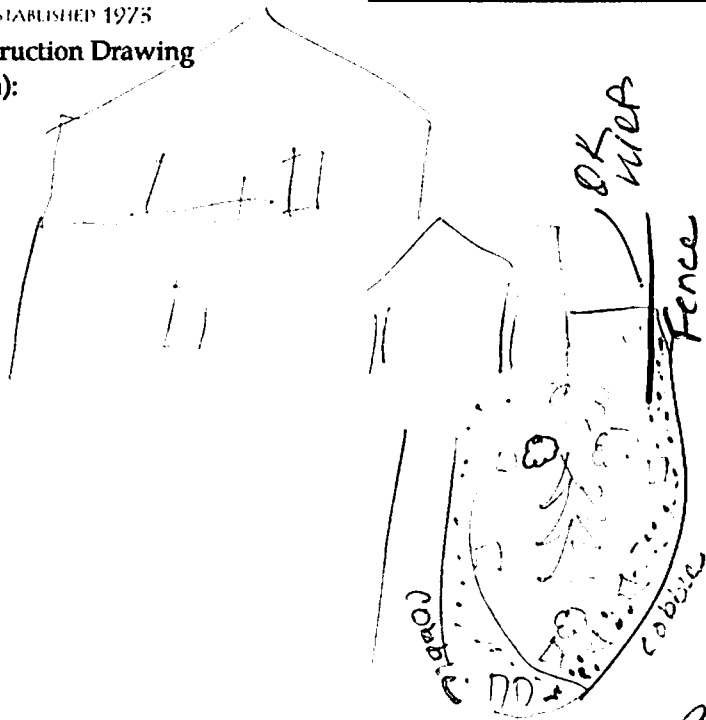

Remove existing
tree in front
of porch

extend fence to
front corner
of porch

Remove all grass

Place 2 rows boulders

✓ Cobble stone

install new smaller tree

& ornamental iron

maintenance shrubs

top soil & mulch